

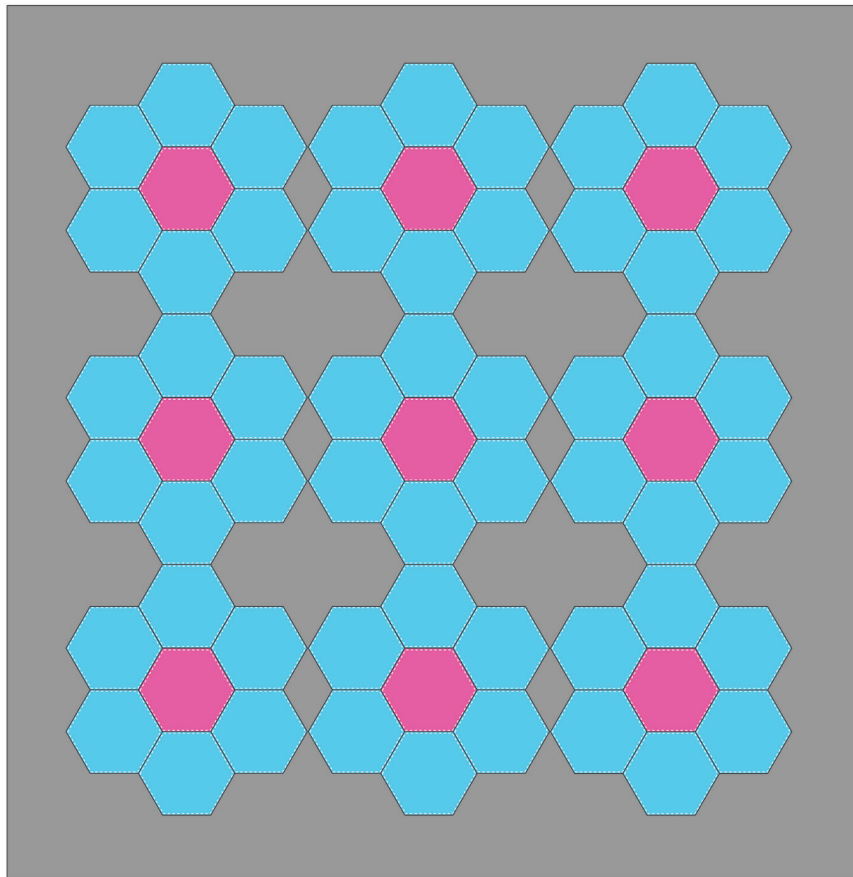

## Extreme Paper Piecing



## Materials

- Photo cardstock for template
- Size varies depending on the project

## Grace Company Products Used

- *360 Wonderfoot* with the “Stitch in the Ditch” insert
- *Ruler Base*
- *TrueCut Rulers*

## Notes

- WOF=width of fabric
- Use a  $\frac{3}{8}$ ” seam allowance



Extreme paper piecing is a new technique that involves making large shapes with a template and then using the *360 Wonderfoot* to tack your fabric directly onto the quilt. Here are the instructions on how to use this technique to make a unique hexagon quilt.

## Cut Your Templates

- Cut a 7.5" hexagon out of a sheet of glossy photo cardstock.
- Use your template and *TrueCut Ruler* to cut 6 hexagons with a  $\frac{3}{8}$ " seam allowance.

## Parchment Paper

- Use spray adhesive to glue your parchment paper to the back of your hexagons. This will make it easier to pull the fabric off later

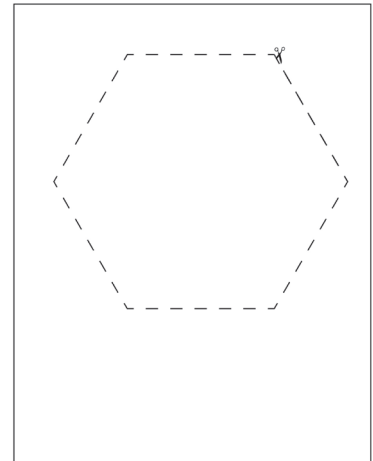

## Grace Education

- Use the same template and ruler to cut one hexagon with  $\frac{3}{8}$ " seam allowance from your green center fabric.

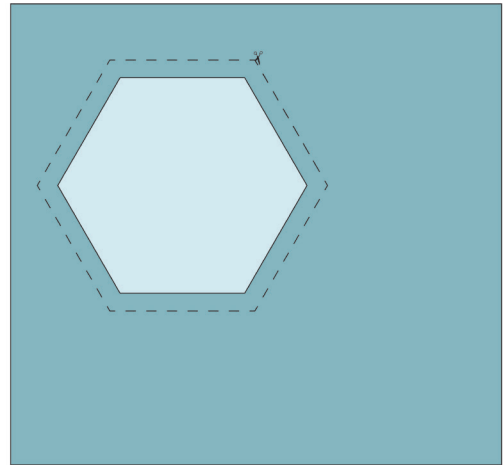
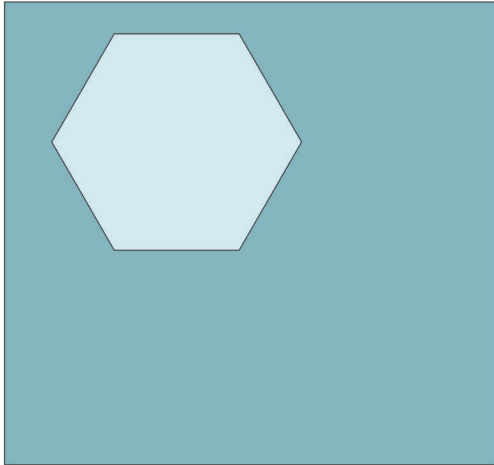

- Center your template on the wrong side of a fabric hexagon.
- Glue along the edge of the template with a glue stick. Fold the edges over the glued edge of the template.
- Press the edges flat with an iron.

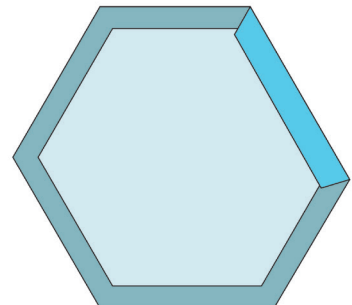
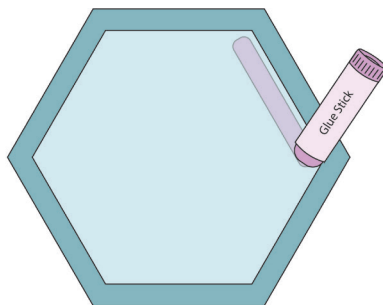
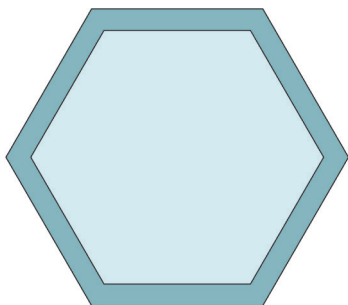

*Pro Tip: It helps to fold every other side*

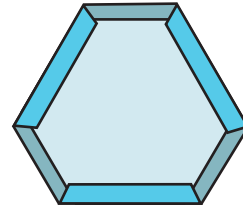

- Once you have all the sides glued down, iron the creases to make crisp folds.

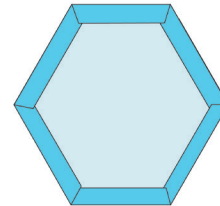

- Carefully unstick your fabric from the edges of the template and remove your template. Press the creases of your fabric again.
- Use the same template and same method to fold and crease the rest of your hexagons.

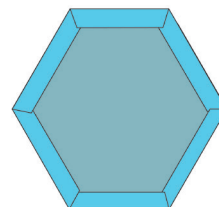

- Place the background fabric on the frame.

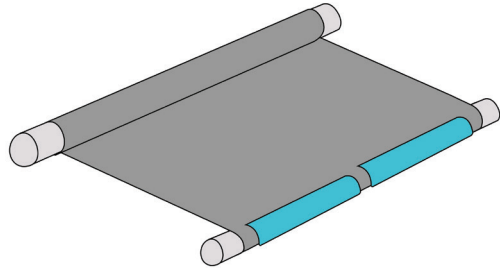

- Using the bar as a guide, sew a straight line across the top of the quilt.

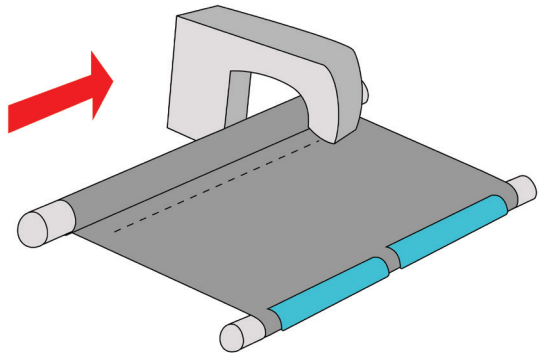

- This straight line will be where you line up your hexagons.

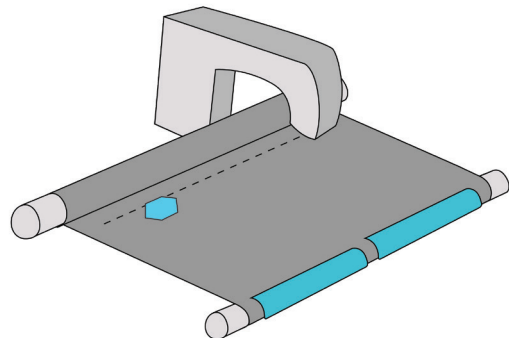

- Carefully tack down the hexagons to the backing using your quilting frame and machine to save you a lot of time!

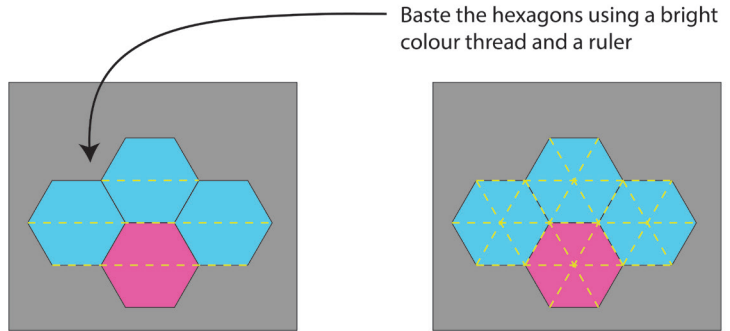

- Once you have tacked all the flowers and centers down, you are ready to do the quilting!
- Ruler work or automation is highly recommended for this project.

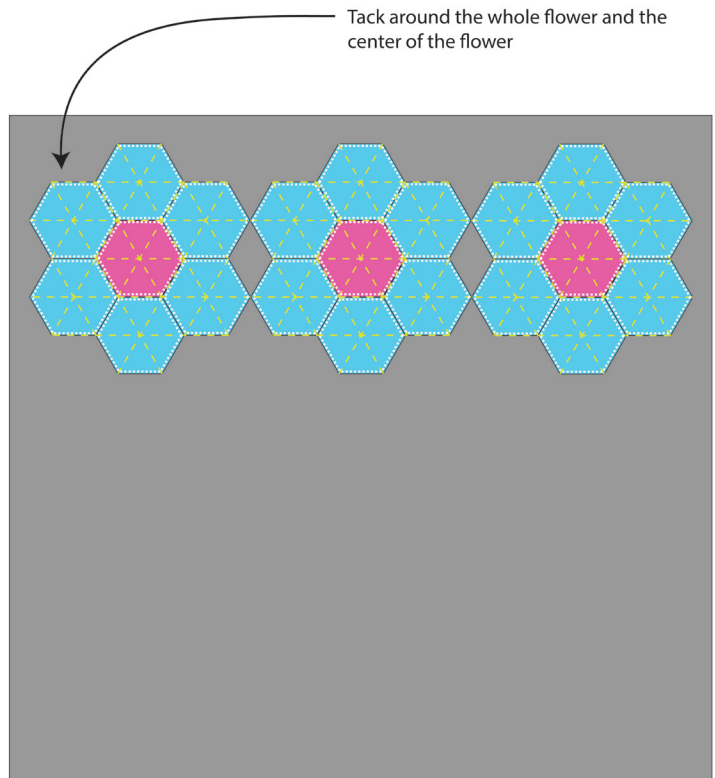

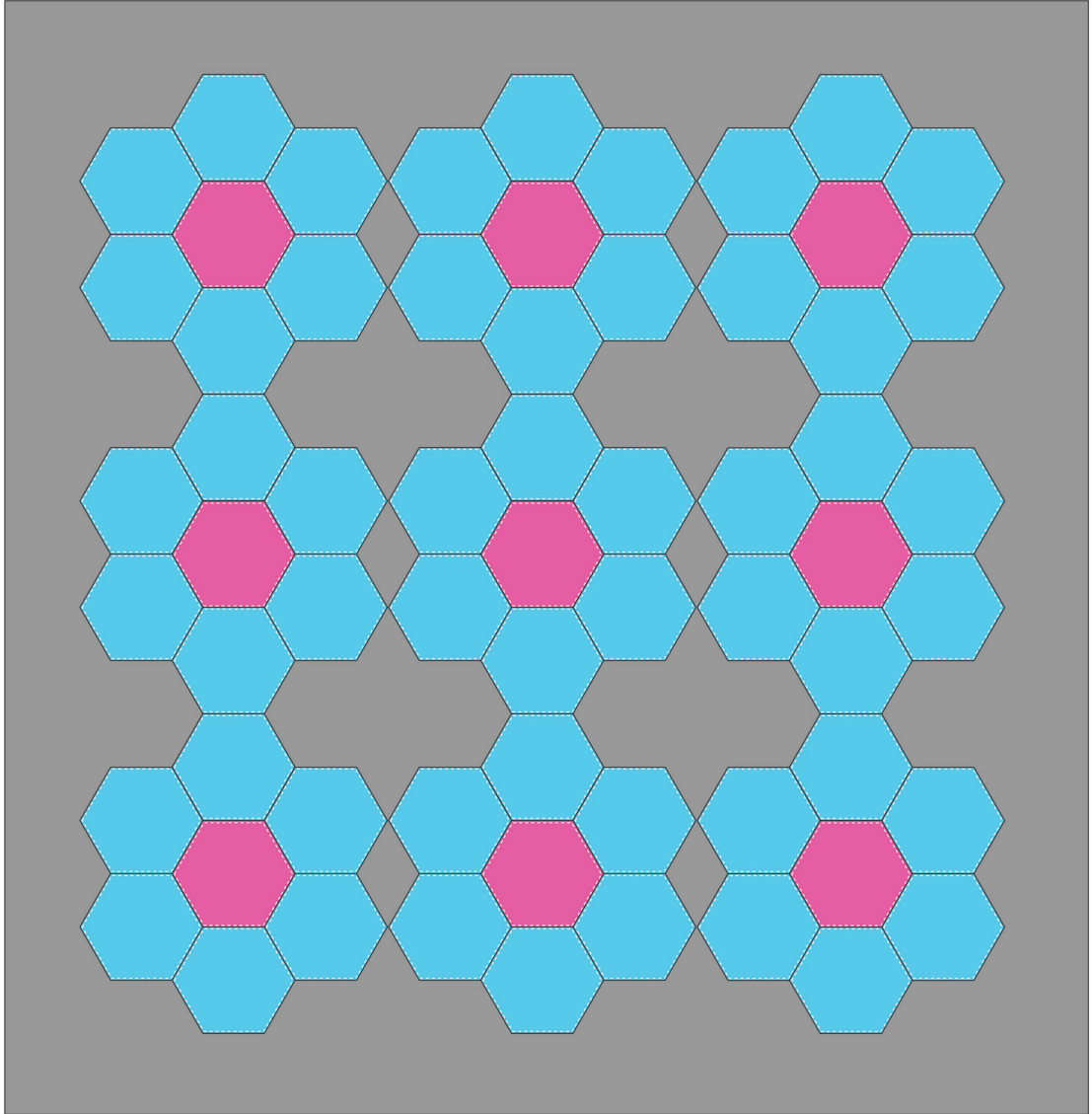



# Variations

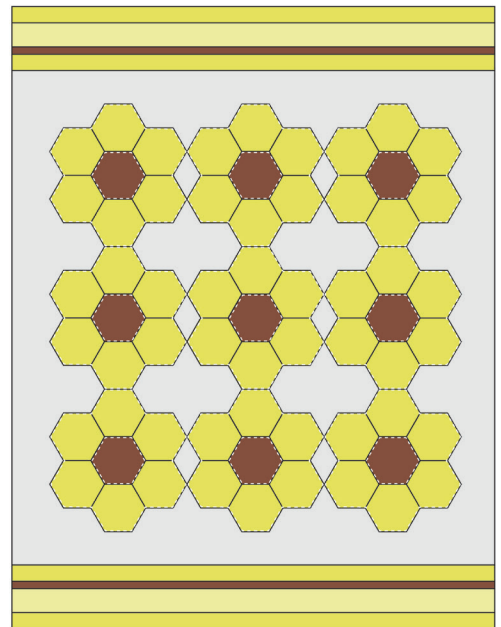
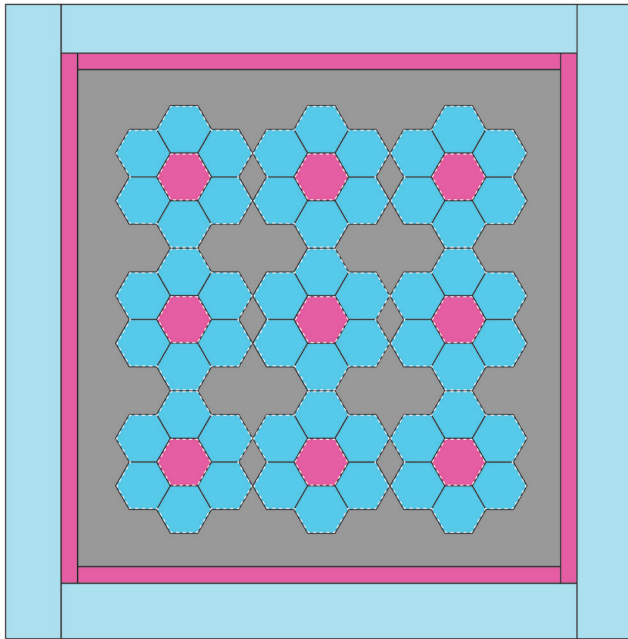

# Template

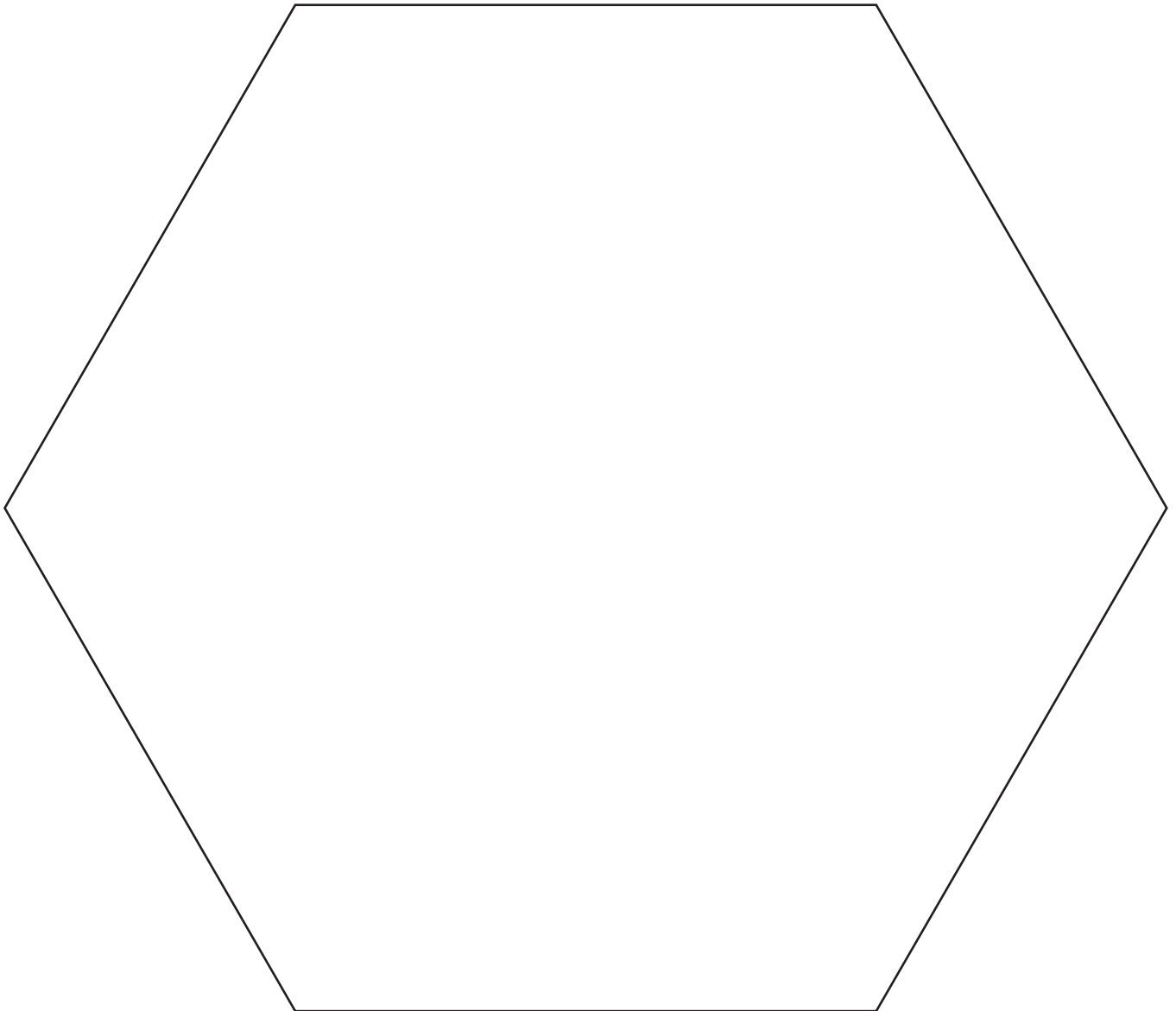



**Contact us!**

Phone: (800) 264-0644

Email: [education@graceframe.com](mailto:education@graceframe.com)

Web: [www.graceframe.com](http://www.graceframe.com)



©The Grace Company  
2225 South 3200 West  
Salt Lake City, UT  
84119 United States